

# *Inductive Sensors*

*M8-Sens*

*M12-Sens*

*New Design*

*New Experience*

**C+R Automations- GmbH**

Nürnberger Straße 45  
90513 Zirndorf

Tel. +49 (0)911 656587-0  
E-Mail: [info@crautomation.de](mailto:info@crautomation.de)  
[www.crautomation.de](http://www.crautomation.de)

# << Inductive Sensor

## Metal Barrel-G series

**M8x1**



### Description:

Brass nickel-plated, threaded barrel, extended operating distance, DC 3-wire output, IP68 protection class, LED indicator.

Inductive Sensors

### Technical Data:

Type	Rated Operating Distance S <sub>n</sub>	Mounting	Output	Voltage Range U <sub>B</sub>	Rated Current	Switching Frequency	Ambient Temperature	Connection	Fig
Fi2-G08-OP6L-Q8	2mm	Flush	PNP NO	10...30VDC	≤200mA	1400Hz	-30...85°C	M8 Connector	Fig.1
Fi2-G08-CP6L-Q8	2mm	Flush	PNP NC	10...30VDC	≤200mA	1400Hz	-30...85°C	M8 Connector	Fig.1
Fi2-G08-OP6L-Q8-60	2mm	Flush	PNP NO	10...30VDC	≤200mA	1400Hz	-30...85°C	M8 Connector	Fig.3
Fi2-G08-CP6L-Q8-60	2mm	Flush	PNP NC	10...30VDC	≤200mA	1400Hz	-30...85°C	M8 Connector	Fig.3
Ni4-G08-OP6L-Q8	4mm	Non-flush	PNP NO	10...30VDC	≤200mA	750Hz	-30...85°C	M8 Connector	Fig.2
Ni4-G08-CP6L-Q8	4mm	Non-flush	PNP NC	10...30VDC	≤200mA	750Hz	-30...85°C	M8 Connector	Fig.2
Ni4-G08-ON6L-Q8	4mm	Non-flush	NPN NO	10...30VDC	≤200mA	750Hz	-30...85°C	M8 Connector	Fig.2
Ni4-G08-CN6L-Q8	4mm	Non-flush	NPN NC	10...30VDC	≤200mA	750Hz	-30...85°C	M8 Connector	Fig.2

### Dimensions:

Fig.1

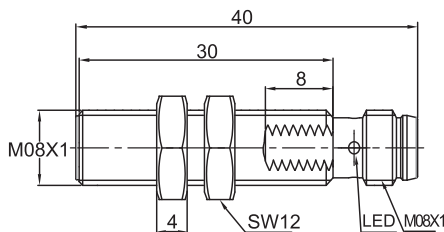

Fig.2

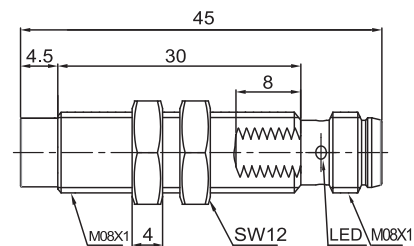
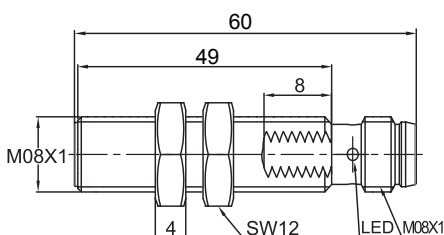

Fig.3



# << Inductive Sensor

## Metal Barrel-G3 series

M8x1



### Description:

Brass nickel-plated, threaded barrel, extended operating distance, DC 3-wire output, IP68 protection class, LED indicator, M8 connector.

Inductive Sensors

### Technical Data:

Type	Rated Operating Distance Sn	Mounting	Output	Voltage Range U <sub>B</sub>	Rated Current	Switching Frequency	Ambient Temperature	Connection	Fig
Fi3-G08-OP6L-Q8	3mm	Flush	PNP NO	10...30VDC	≤200mA	500Hz	-25...70°C	M8 Connector	Fig.1
Fi3-G08-CP6L-Q8	3mm	Flush	PNP NC	10...30VDC	≤200mA	500Hz	-25...70°C	M8 Connector	Fig.1
Fi3-G08-ON6L-Q8	3mm	Flush	NPN NO	10...30VDC	≤200mA	500Hz	-25...70°C	M8 Connector	Fig.1
Fi3-G08-CN6L-Q8	3mm	Flush	NPN NC	10...30VDC	≤200mA	500Hz	-25...70°C	M8 Connector	Fig.1
Ni6-G08-OP6L-Q8	6mm	Non-flush	PNP NO	10...30VDC	≤200mA	500Hz	-25...70°C	M8 Connector	Fig.2
Ni6-G08-CP6L-Q8	6mm	Non-flush	PNP NC	10...30VDC	≤200mA	500Hz	-25...70°C	M8 Connector	Fig.2
Ni6-G08-ON6L-Q8	6mm	Non-flush	NPN NO	10...30VDC	≤200mA	500Hz	-25...70°C	M8 Connector	Fig.2
Ni6-G08-CN6L-Q8	6mm	Non-flush	NPN NC	10...30VDC	≤200mA	500Hz	-25...70°C	M8 Connector	Fig.2

### Dimensions:

Fig.1

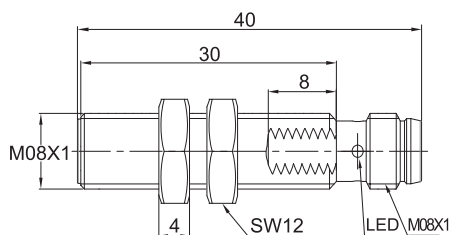
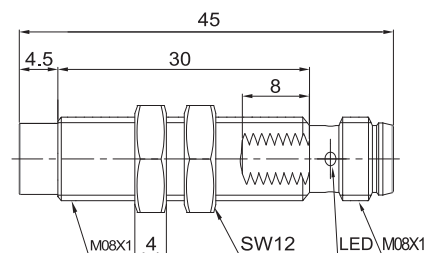

Fig.2



# << Inductive Sensor

## Metal Barrel-M12

### M12x1



### Description:

Brass nickel-plated, threaded barrel, extended operating distance, DC 3-wire output, IP67 protection class, LED indicator.

### Technical Data:

Type	Rated Operating Distance S <sub>n</sub>	Mounting	Output	Voltage Range U <sub>p</sub>	Rated Current				
Fi4-M12-OP6L-Q12	4mm	Flush	PNP NO	10...30VDC	≤200mA	650Hz	-25...70°C	M12 Connector	
Fi4-M12-ON6L-Q12	4mm	Flush	NPN NO	10...30VDC	≤200mA	650Hz	-25...70°C	M12 Connector	
Fi4-M12-CP6L-Q12	4mm	Flush	PNP NC	10...30VDC	≤200mA	650Hz	-25...70°C	M12 Connector	
Fi4-M12-CN6L-Q12	4mm	Flush	NPN NC	10...30VDC	≤200mA	650Hz	-25...70°C	M12 Connector	
Ni8-M12-OP6L-Q12	8mm	Non-flush	PNP NO	10...30VDC	≤200mA	500Hz	-25...70°C	M12 Connector	
Ni8-M12-ON6L-Q12	8mm	Non-flush	NPN NO	10...30VDC	≤200mA	500Hz	-25...70°C	M12 Connector	
Ni8-M12-CP6L-Q12	8mm	Non-flush	PNP NC	10...30VDC	≤200mA	500Hz	-25...70°C	M12 Connector	
Ni8-M12-CN6L-Q12	8mm	Non-flush	NPN NC	10...30VDC	≤200mA	500Hz	-25...70°C	M12 Connector	

### Dimensions:

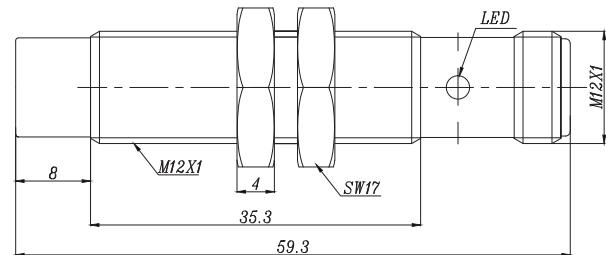
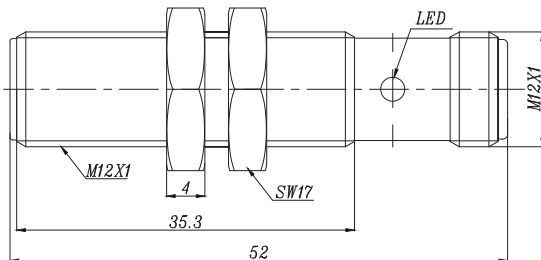

# << Inductive Sensor

## Metal Barrel-M12S (Short)

### M12x1



### Description:

Brass nickel-plated, threaded barrel, extended operating distance, DC 3-wire output, IP67 protection class, LED indicator.

### Technical Data:

Type	Rated Operating Distance Sn	Mounting	Output	Voltage Range U <sub>p</sub>	Rated Current				
Fi4-M12S-OP6L-Q12	4mm	Ø • @	PNP NO	10...30VDC	≤100mA	650Hz	-25...70°C	M12 Connector	
Fi4-M12S-ON6L-Q12	4mm	Ø • @	NPN NO	10...30VDC	≤100mA	650Hz	-25...70°C	M12 Connector	
Fi4-M12S-CP6L-Q12	4mm	Ø • @	PNP NC	10...30VDC	≤100mA	650Hz	-25...70°C	M12 Connector	
Fi4-M12S-CN6L-Q12	4mm	Ø • @	NPN NC	10...30VDC	≤100mA	650Hz	-25...70°C	M12 Connector	
Ni8-M12S-OP6L-Q12	8mm	Non-flush	PNP NO	10...30VDC	≤100mA	500Hz	-25...70°C	M12 Connector	
Ni8-M12S-ON6L-Q12	8mm	Non-flush	NPN NO	10...30VDC	≤100mA	500Hz	-25...70°C	M12 Connector	
Ni8-M12S-CP6L-Q12	8mm	Non-flush	PNP NC	10...30VDC	≤100mA	500Hz	-25...70°C	M12 Connector	
Ni8-M12S-CN6L-Q12	8mm	Non-flush	NPN NC	10...30VDC	≤100mA	500Hz	-25...70°C	M12 Connector	

### Dimensions:

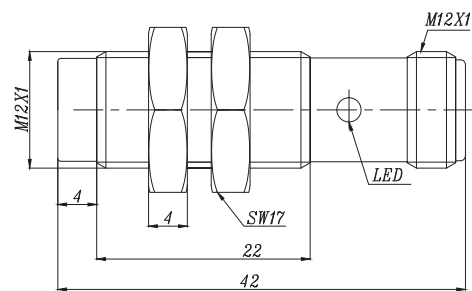
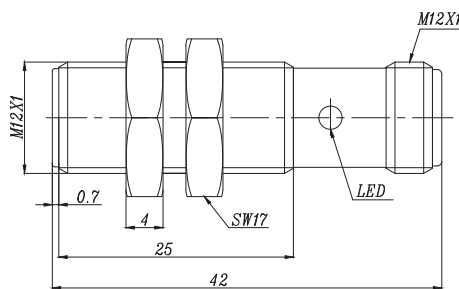

# << Inductive Sensor

## Metal Barrel-G series

### M12x1



### Description:

Brass nickel-plated, threaded barrel, extended operating distance, DC 3-wire output, IP68 protection class, LED indicator.

### Technical Data:

Type	Rated Operating Distance S <sub>n</sub>	Mounting	Output	Voltage Range U <sub>B</sub>	Rated Current	Switching Frequency	Ambient Temperature	Connection	Fig
Fi4-G12-OP6L-Q12	4mm	Flush	PNP NO	10...30VDC	≤200mA	650Hz	-30...85°C	M12 Connector	Fig.1
Fi4-G12-CP6L-Q12	4mm	Flush	PNP NC	10...30VDC	≤200mA	650Hz	-30...85°C	M12 Connector	Fig.1
Fi4-G12-ON6L-Q12	4mm	Flush	NPN NO	10...30VDC	≤200mA	650Hz	-30...85°C	M12 Connector	Fig.1
Fi4-G12-CN6L-Q12	4mm	Flush	NPN NC	10...30VDC	≤200mA	650Hz	-30...85°C	M12 Connector	Fig.1
Ni6-G12-OP6L-Q12	6mm	Non-flush	PNP NO	10...30VDC	≤200mA	600Hz	-30...85°C	M12 Connector	Fig.2
Ni6-G12-CP6L-Q12	6mm	Non-flush	PNP NC	10...30VDC	≤200mA	600Hz	-30...85°C	M12 Connector	Fig.2
Ni6-G12-ON6L-Q12	6mm	Non-flush	NPN NO	10...30VDC	≤200mA	600Hz	-30...85°C	M12 Connector	Fig.2
Ni6-G12-CN6L-Q12	6mm	Non-flush	NPN NC	10...30VDC	≤200mA	600Hz	-30...85°C	M12 Connector	Fig.2
Ni8-G12-OP6L-Q12	8mm	Non-flush	PNP NO	10...30VDC	≤200mA	500Hz	-30...85°C	M12 Connector	Fig.2
Ni8-G12-CP6L-Q12	8mm	Non-flush	PNP NC	10...30VDC	≤200mA	500Hz	-30...85°C	M12 Connector	Fig.2
Ni8-G12-ON6L-Q12	8mm	Non-flush	NPN NO	10...30VDC	≤200mA	500Hz	-30...85°C	M12 Connector	Fig.2
Ni8-G12-CN6L-Q12	8mm	Non-flush	NPN NC	10...30VDC	≤200mA	500Hz	-30...85°C	M12 Connector	Fig.2

### Dimensions:

Fig.1

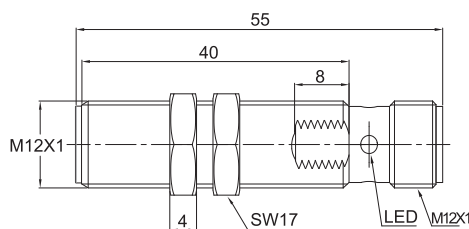
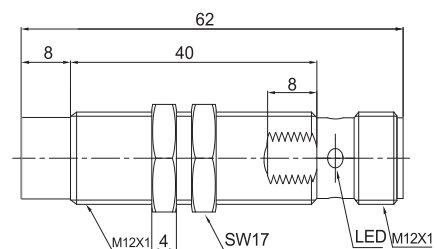

Fig.2



# << Inductive Sensor

## Metal Barrel-G3 series

### M12x1



### Description:

Brass nickel-plated, threaded barrel, extended operating distance, DC 3-wire output, IP68 protection class, LED indicator, M12 connector.

### Technical Data:

Type	Rated Operating Distance S <sub>n</sub>	Mounting	Output	Voltage Range U <sub>B</sub>	Rated Current	Switching Frequency	Ambient Temperature	Connection	Fig
Fi6-G12-OP6L-Q12	6mm	Flush	PNP NO	10...30VDC	≤200mA	500Hz	-25...70°C	M12 Connector	Fig.1
Fi6-G12-CP6L-Q12	6mm	Flush	PNP NC	10...30VDC	≤200mA	500Hz	-25...70°C	M12 Connector	Fig.1
Fi6-G12-ON6L-Q12	6mm	Flush	NPN NO	10...30VDC	≤200mA	500Hz	-25...70°C	M12 Connector	Fig.1
Fi6-G12-CN6L-Q12	6mm	Flush	NPN NC	10...30VDC	≤200mA	500Hz	-25...70°C	M12 Connector	Fig.1
Ni10-G12-OP6L-Q12	10mm	Non-flush	PNP NO	10...30VDC	≤200mA	500Hz	-25...70°C	M12 Connector	Fig.2
Ni10-G12-CP6L-Q12	10mm	Non-flush	PNP NC	10...30VDC	≤200mA	500Hz	-25...70°C	M12 Connector	Fig.2
Ni10-G12-ON6L-Q12	10mm	Non-flush	NPN NO	10...30VDC	≤200mA	500Hz	-25...70°C	M12 Connector	Fig.2
Ni10-G12-CN6L-Q12	10mm	Non-flush	NPN NC	10...30VDC	≤200mA	500Hz	-25...70°C	M12 Connector	Fig.2

### Dimensions:

Fig.1

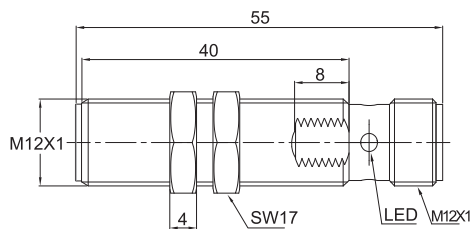

Fig.2

